



topcoilsite.com

25 TON ROD SPINNER Operators Manual

Canadian Patent 2,282,822
United States Patent 6,253,844



557-501-500
7/8 inch Rod

557-501-600
1 inch Rod

Content	Page
Trico Customers.....	2
Assembly Drawing.....	3
Critical Area Drawing.....	4
Operation.....	5
Maintenance.....	6

Document: M5
Revision: A
Printed: August 2018
Author: Jordan Simpson

Thank-you for choosing Trico. We at Topco Oilsite Products design and build Trico equipment with you, the customer in mind.

To help ensure trouble-free operation of your equipment, read this manual carefully and follow its recommendations.

An authorized Topco facility knows your equipment best. So when maintenance or service is necessary, that's the place to go.



General Cautions and Warnings

Maximum working load indicates the greatest force or load a product can carry under usual environmental conditions. Shock loading and extraordinary conditions will reduce the maximum working load rating. The maximum working load rating may also be affected by wear, misuse, overloading, corrosion, deformation, intentional alteration, and other use conditions.

Regular inspection shall be conducted to determine whether use can be continued at the maximum working load rating, a reduced maximum working load rating, or whether the product shall be withdrawn from service.

Important Notes About This Manual

All specifications and descriptions are accurate at the time of printing. Because continuous improvement is a goal at Topco, we reserve the right to make changes in specifications at any time without notice and without obligation.

Please be aware that this manual applies to all models, equipment, and options. As a result, you may find some explanations not applicable to your equipment.



Quality

If you have any questions, concerns, or feedback regarding the quality of our products and services please contact us.

Safety

Ensure equipment is operated in accordance with all government, regulatory and employer requirements.

Markings

-  This symbol in the manual means "Do not let this happen."
-  This symbol means failure to comply may result in damage or injury.

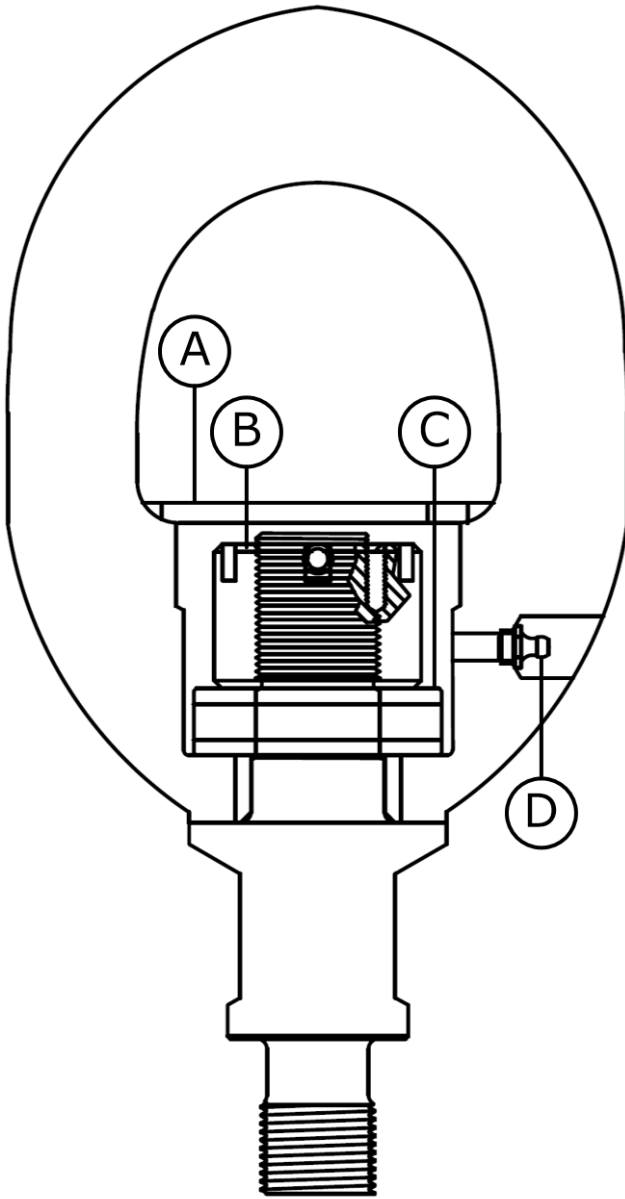

A. Grease Cap

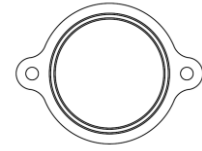

554-542-500

Grease Cap Gasket

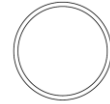

554-542-500G

2x Grease Cap Screw



554-542-600

B. Nut & Pin

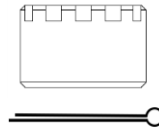

554-542-901

C. Bearing

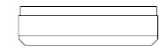

554-543-400

D. Grease Zerk



554-578-700

Wear Limits	Critical Area
Clevis Seat Minimum 1.9 in (48 mm)	

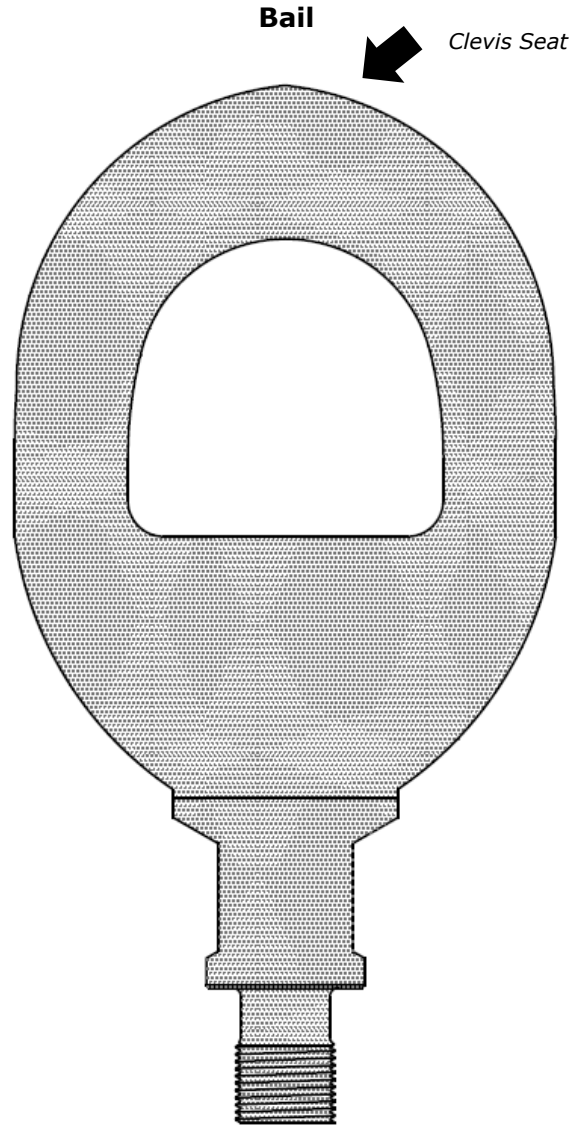



WARNING: Failure to follow these directions could result in damage or injury.

- ▶ Only lift Rod Spinners in a vertical direction using the clevis seat.
- ▶ Never operate without grease or if the bearing or threads are damaged and rotation is impeded.
- ▶ Never exceed the maximum working load of the Spinner.

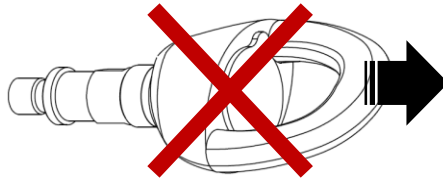

New Equipment Specifications

- ▶ Maximum Working Load: 25 short tons (50,000 lbs).

Before Each Use

- ▶ Ensure the bail freely rotates in both directions, and is tightly secured to the body.
- ▶ Ensure the bearing is lubricated for every 8 hours of operation using a NLGI certified grease meeting GC-LB standards.
- ▶ Check the threads for damage.
- ▶ Check the condition of the bearing. *High rotational speeds and heavy operating loads reduce bearing life.*
- ▶ Verify the lower shank **(A)** freely rotates in both directions, and is **(B)** tightly secured to the bail.

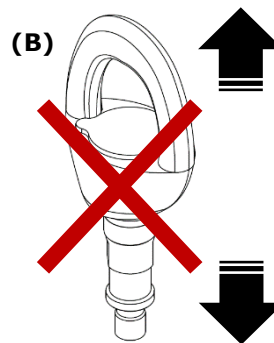
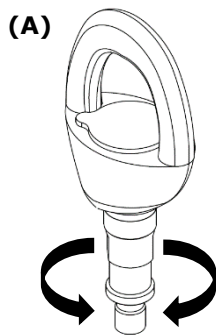



WARNING: Failure to follow these directions could result in damage or injury.

- ▶ Never weld, grind, or modify in any way.
- ▶ Only use Trico Original Equipment Manufacturer (“OEM”) replacement parts.
- ▶ Never operate a Spinner with a Non-OEM bearing.
- ▶ Never install a nut without a pin.



Recommended Maintenance Practice

API Recommended Practice 8B and CAODC Recommended Practice 4.0 are approved for the maintenance of Trico Rod Spinners. At a minimum, it is recommended that all Category/Level III and IV maintenance be conducted at an authorized Trico inspection facility.

Recommended Maintenance Schedule

This schedule is a guide only. The equipment owner/operator should consider the following factors when building a maintenance schedule; environment, load cycles and operating time.

Category	Level	Type	Frequency		Method	Corrective Action
			API	CAODC		
I		Visual	1 day (Daily)	1 day (Daily)	<ul style="list-style-type: none"> • Observation during operation 	Contact Topco to locate an authorized Trico inspection facility.
II		Visual	7 days (Weekly)	7 days (Weekly)	<ul style="list-style-type: none"> • Cracks • Loose connections • Yielding • Wear • Corrosion 	
III		Physical	6 months (Bi-annually)	1 year (Annually)	<ul style="list-style-type: none"> • NDT of critical areas • Wear limits 	
IV		Disassembly	1 year (Annually)	6 years	<ul style="list-style-type: none"> • Inspection at an authorized Trico facility 	

Contact Information

Canada & International

Toll free: 1 800 222 6448
 Edmonton: 780 436 3400
 ContactUs@TopcoOilsite.com
 TopcoOilsite.com



USA

Permian Basin: 432 296 7040
 ContactUs@TopcoOilsite.com
 TopcoOilsite.com

